



CHARTER PRICELIST 2010

Euro per week

Included: 10% Croatian VAT., luxury bedding, towels, gas, electric winch for halyards, self tacking jib

Location: Marina Dalmacija, Sukosan

<u>Sailing Yachts</u>	<u>Built of Year</u>	<u>Cabins</u>	<u>Sails</u>	<u>"Until 3.04. from 09.10. "</u>	<u>"3.04. - 22.05. 18.09. - 09.10."</u>	<u>"22.05. - 26.06. 11.09. - 18.09. "</u>	<u>"26.06. – 31.07. 14.08. - 11.09. "</u>	<u>"31.07. – 14.08"</u>	<u>Deposit</u>
Hanse 350	2008	3	Mainsail lazy yack	900	1.050	1.400	1.750	2.100	1.000
Hanse 370	2008	3	Mainsail lazy yack	1.300	1.450	1.750	2.100	2.400	1.500
Hanse 400	2008	3	Mainsail lazy yack	1.550	1.800	2.200	2.600	2.800	1.500
Hanse 400	2008	3	Mainsail lazy yack	1.550	1.800	2.200	2.600	2.800	1.500
Hanse 430	2008	3	Mainsail lazy yack	1.900	2.100	2.700	2.900	3.300	1.500
Hanse 430	2008	3	Mainsail lazy yack	1.900	2.100	2.700	2.900	3.300	1.500
Hanse 470	2008	3	Mainsail lazy yack	2.400	2.700	2.970	3.600	4.050	1.500
Hanse 470	2008	3	Mainsail lazy yack	2.400	2.700	2.970	3.600	4.050	1.500
Hanse 540	2008	3	Mainsail lazy yack	4.050	4.700	5.000	5.300	5.600	2.000
Hanse 540	2008	3	Mainsail lazy yack	4.050	4.700	5.000	5.300	5.600	2.000

Extra to pay (locally)

Permit : € 150,00 per Charter (mandatory)

Outboard : € 80,00 per week

Skipper : € 150,00 per day + food

Hostess : € 130,00 per day + food

More week discount : 5 % for 2 weeks, 10 % for 3 weeks

Early booking discount : 5 % until 31.12.2008

Check in : Saturday 05.00 p.m.

Check out : Saturday 09.00 a.m.

Deposit : 5 % of the a.m. weekly price, minimum € 100,- only in cash (NO DEPOSIT) Back to Marina Dalmacija until Friday latest 05.00 p.m.

MISTAKES AND SUBJECT TO CHANGE!

**Hanse 350****Specifications**

Hull length 10.50 m
Beam 3.55 m
Draft 1.85 m
Displacement 5.76 t
Engine 15.3 kW / 21 HP
Fresh water 260 l
Fuel tank 110 l
CE Certificate A (ocean)
Total sail area 64.86 m²
Main sail 35.25 m²
Self-tacking jib 29.61 m²

Hanse 400**Specifications**

Hull length 11.99 m
Beam 4.04 m
Draft 1.98 m
Displacement 8.4 t
Engine 29.5 kW / 40 HP
Fresh water 300 l
Fuel tank 140 l
CE Certificate A (ocean)
Total sail area 105.60 m²
Main sail 52.20 m²
Self-tacking jib 36.20 m²

Hanse 430**Specifications**

Hull length 13.15 m
Beam 4.18 m
Draft 2.20 m
Displacement 10.9 t
Engine 29.5 kW / 40 HP
Fresh water 320 l
Fuel tank 220 l
CE Certificate A (ocean)
Total sail area 123.50 m²
Main sail 63.00 m²
Self-tacking jib 39.00 m²

Hanse 470**Specifications**

Hull length 14.19 m
Beam 4.46 m
Draft 2.60 m
Displacement 12.2 t
Engine 41 kW / 55 HP
Fresh water 400 l
Fuel tank 250 l
CE Certificate A (ocean)
Total sail area 124 m²
Main sail 67,50 m²
Self-tacking jib 48,30 m²

Hanse 540**Specifications**

Hull length 16.08 m
Beam 4.91 m
Draft 2.80 m
Displacement 18.7 t
Engine 81 kW / 110 HP
Fresh water 690 l
Fuel tank 375 l
CE Certificate A (ocean)
Total sail area 155.00 m²
Main sail 85.10 m²
Self-tacking jib 58.00 m²

Design: judel / vrolijk & co

Standard Equipment:

- Complete Simrad Equipment with Auto pilot and card plotter
- Radio with connection for Mp3 player
- Safety equipment included life raft
- Cushion on deck
- Diving equipment

Hanse 350 (6 persons)

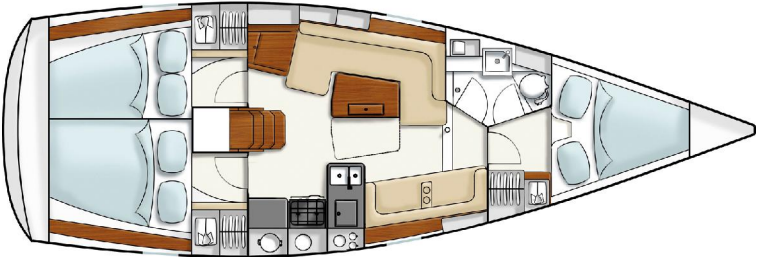

Hanse 400 (6 persons / 2 toilets)

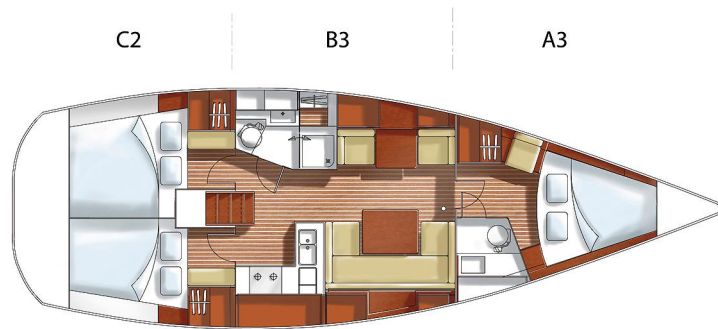

Hanse 430 (6 persons/2 toilets)

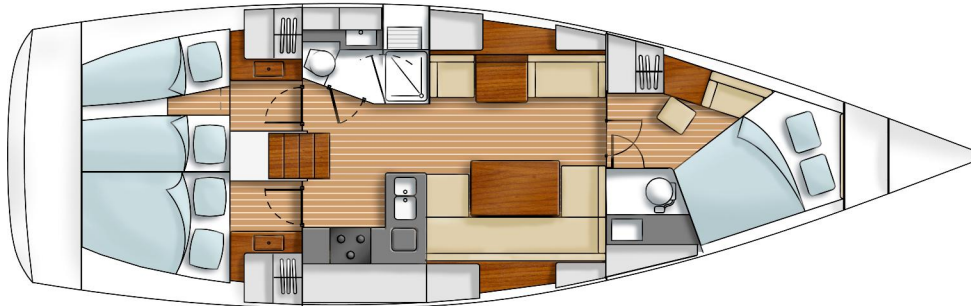

Hanse 470 (6 persons)

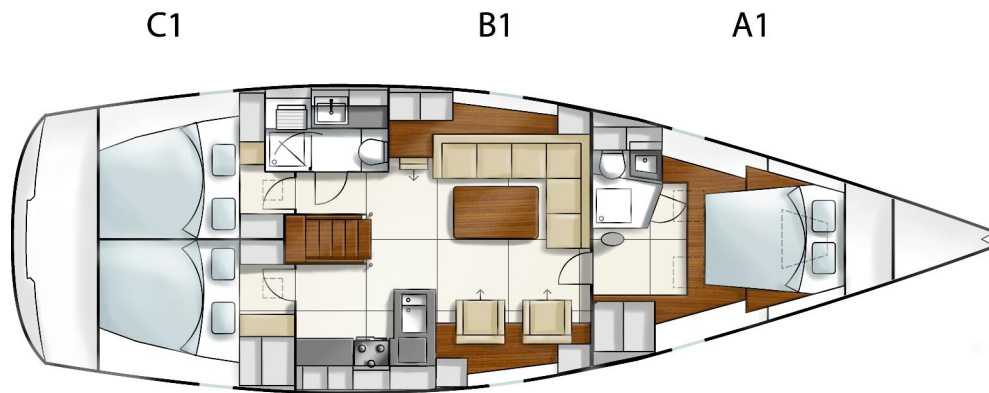

Hanse 540 (9 persons / extra saloon berth with folding table leg + skipper room) 3 Toilets with douches

D1

C1

B1

A1

